

- 1) Please make sure that your callsign has been entered in your radio. If not, please refer the Operator Manual.
- 2) Enter the output frequency of GB7MT 439.6625MHz

Make sure the radio is in VFO mode.

Touch  to toggle between VFO and Memory mode.

Press 

The function menu will be displayed.

Touch 

The number input screen will be displayed.

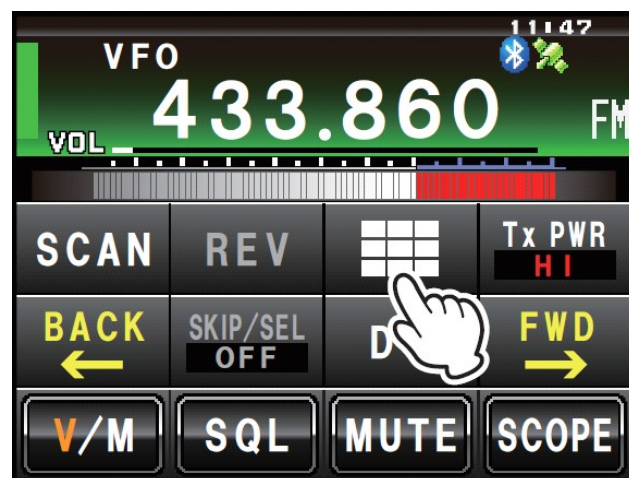
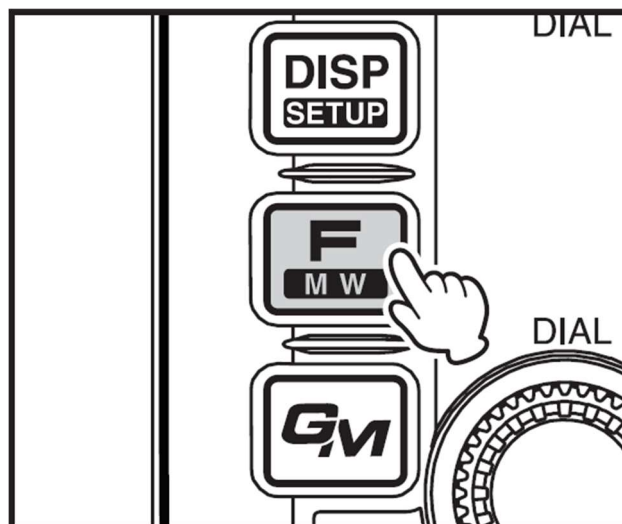
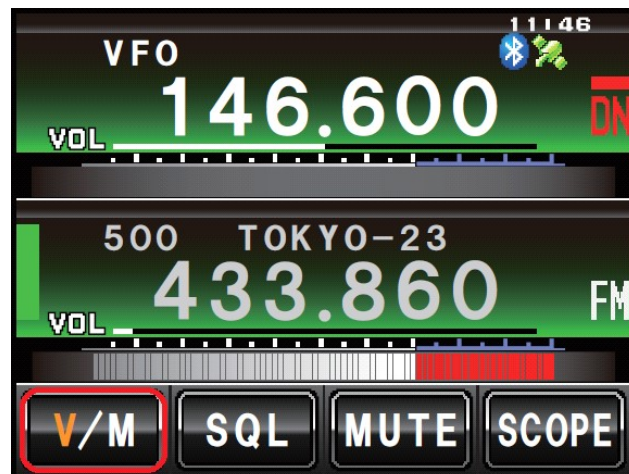

Touch the numbers

[4] [3] [9] [6] [6] [2]

The Frequency 439.662⁵⁰ will be displayed on the screen.

Press **[F]** to hide the function menu.



3) Set the mode to C4FM.

Press the **[D]** button until **○○** above the mode indication is displayed. This will put the radio in AMS mode, the radio will automatically switch between DN, VW or FM.

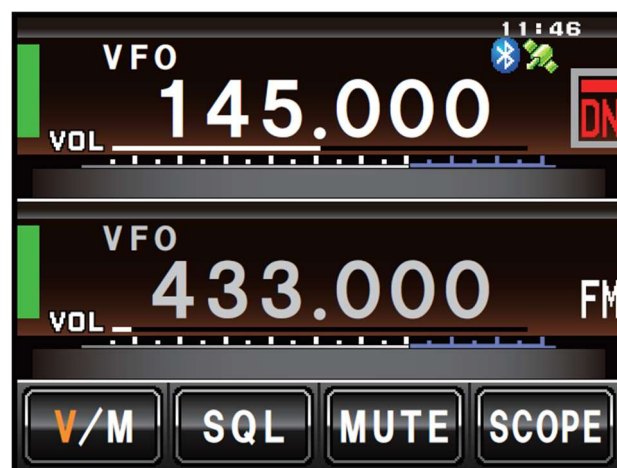

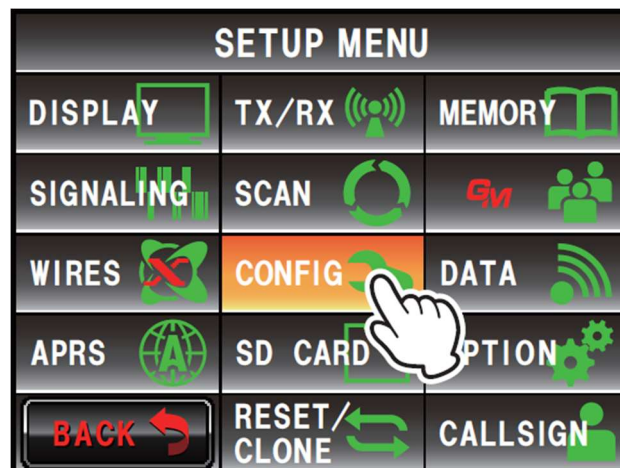

4) Setup the repeater shift frequency

Press **[DISP SETUP]** for one second or longer.
The Setup Menu will be displayed.
Touch CONFIG

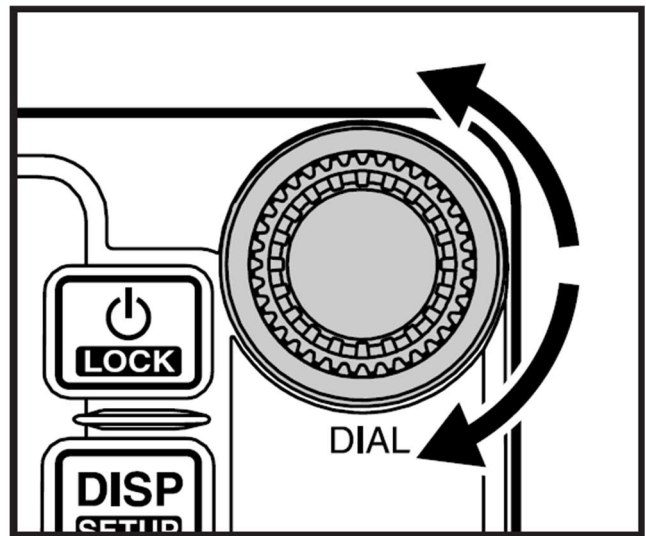

Turn  to select **[5 RPT SHIFT]**
Touch **[5 RPT SHIFT]** until – is displayed



Turn  to select **[6 RPT SHIFT FREQ]**
Touch **[6 RPT SHIFT FREQ]** so that the current repeater shift frequency is highlighted in yellow.

Turn  until the repeater shift frequency is 9.00 MHz.

Touch  three times until the radio is back at the main frequency display.

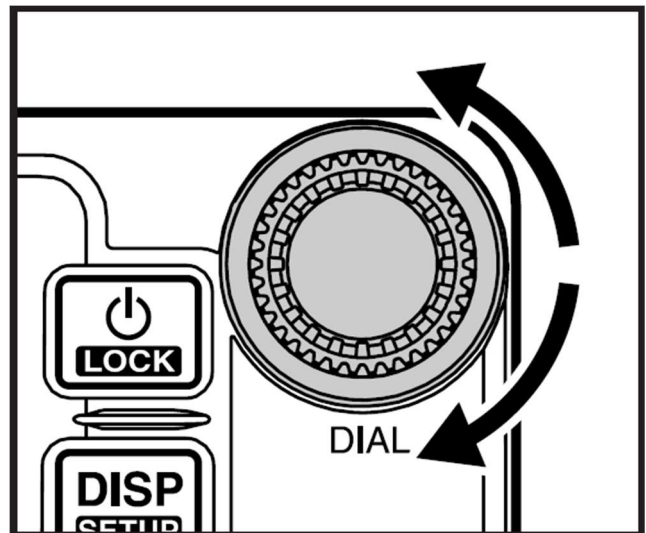

5) Store the repeater frequencies into a memory channel.

Press  for one second or longer.
The memory writing screen will be displayed.
The frequency will be automatically displayed in the next empty memory channel.

Turn  to select a different memory channel if desired.

Press  to save the data to memory.

If you wish to name the memory channel please refer to Page 70 Steps 1 to 11 in “Naming the memory” in the operating manual.

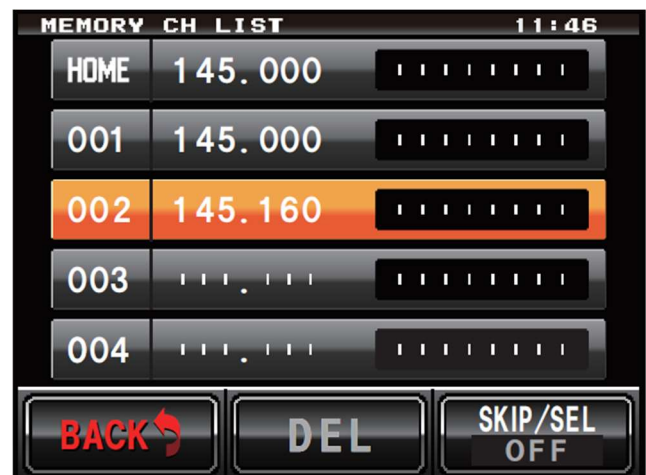

Press  to save the data to memory.

When the memory writing is completed the frequency and memory channel number will be shown in the display.

Touch  to toggle between VFO and Memory mode.

